

# CONVENTION PLAZA

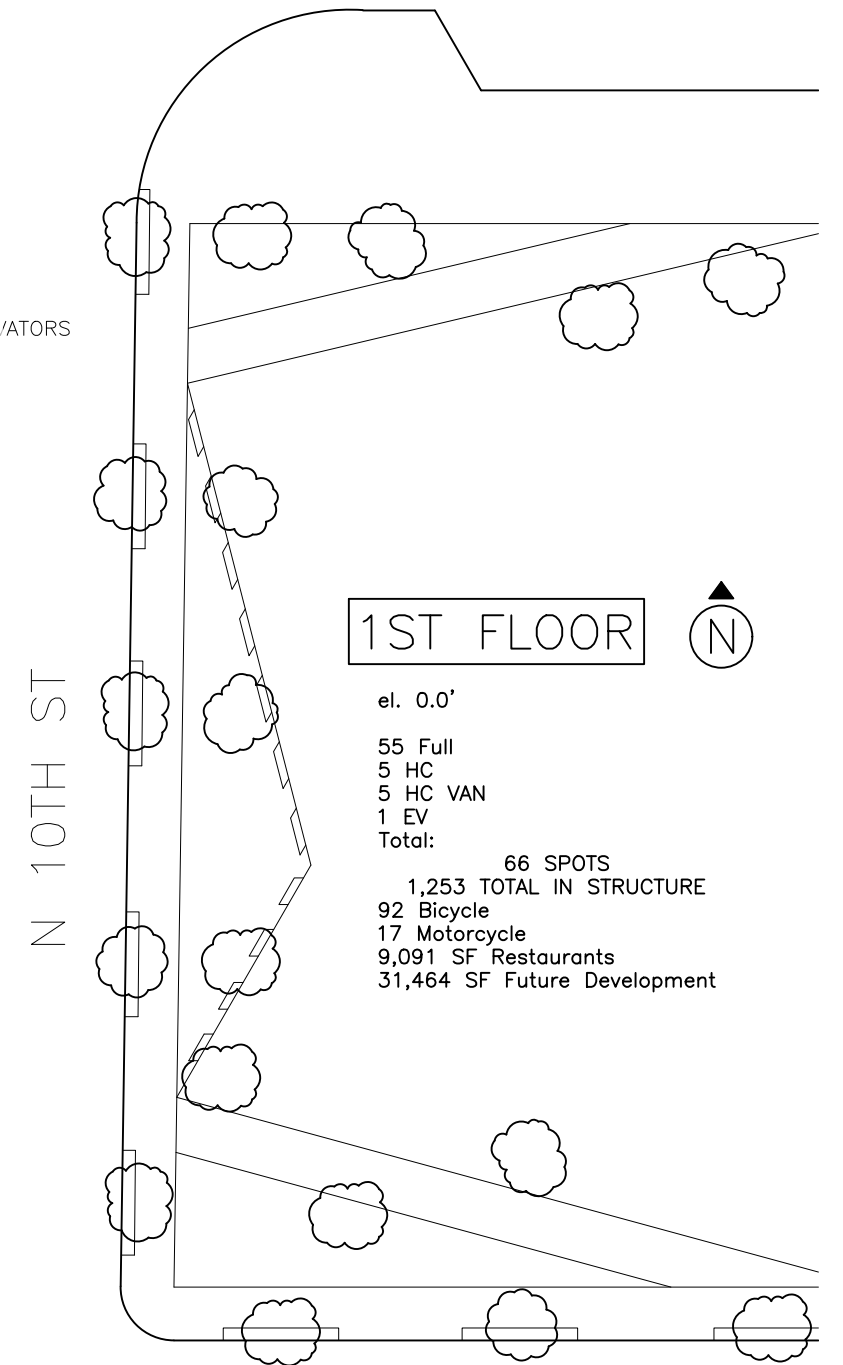
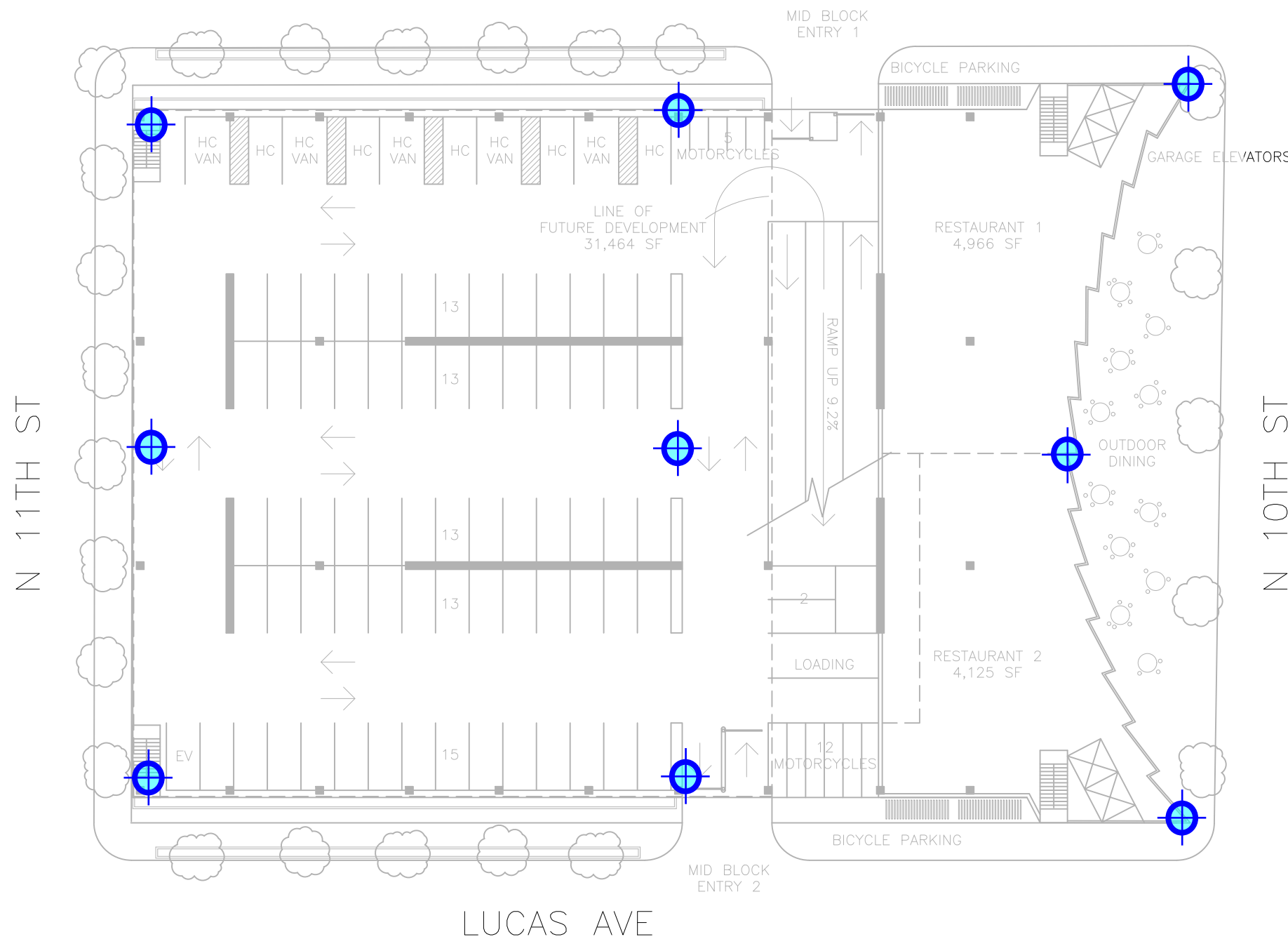

## Notes Regarding These Suggested Borings

1. The quantity and locations are suggested. The geotechnical engineer may deem that more or less borings are required based on their local experience.
2. Typical column loads will be approx. 2500 kips service (DL + LL).
3. Net uplift of approx. 500 kips can be expected in some locations.
4. The seismic base shear is approx 1800 kips (service load level).

## Suggested Boring Locations

KPFF April 19, 2022